

REVISIONS		
DATE	NAME	NO.

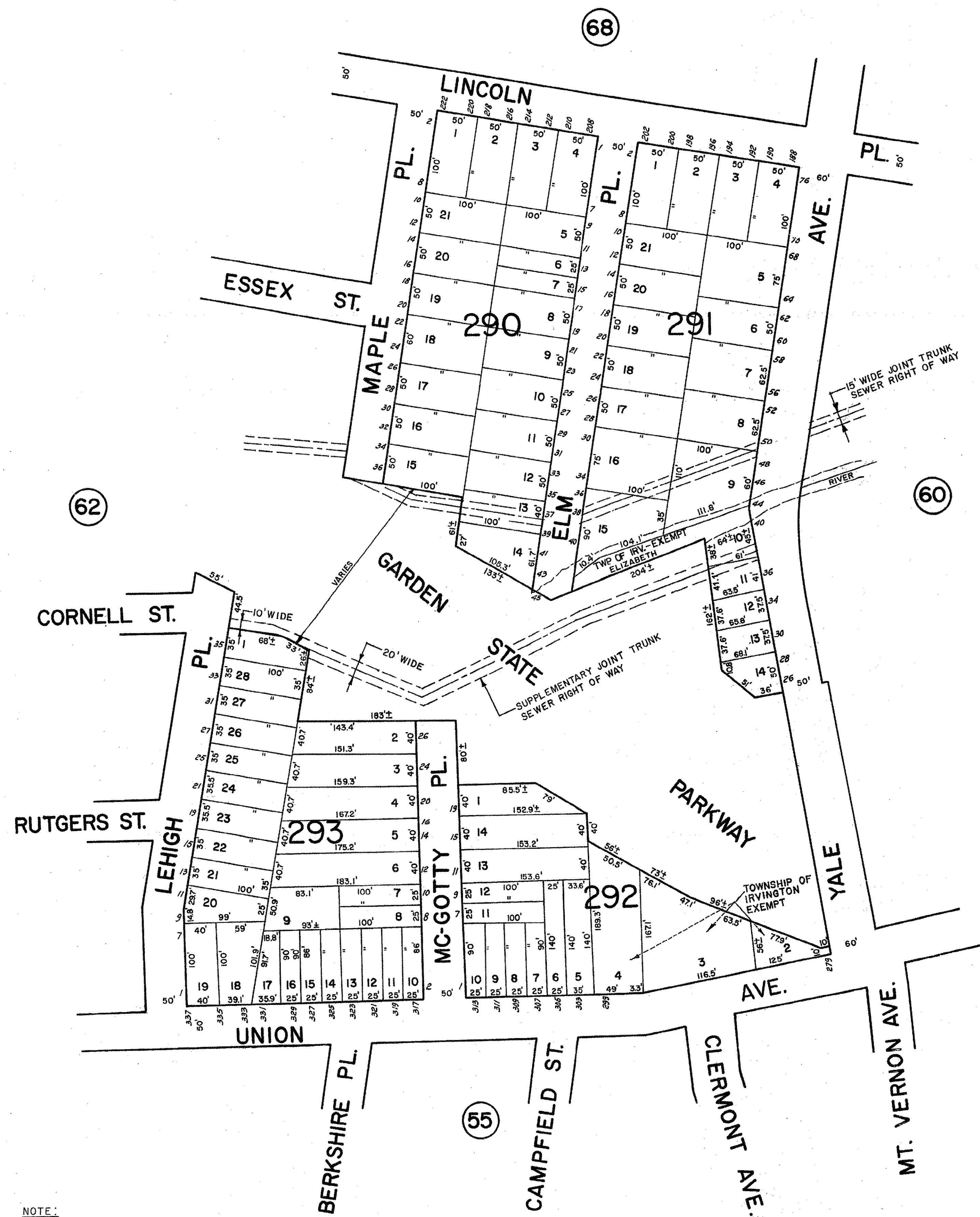

NOTE:  
RIGHT OF WAY WIDTH AND LOCATION OF JOINT  
TRUNK SEWER AND SUPPLEMENTARY JOINT  
TRUNK SEWER EASEMENTS SHOWN HEREON ARE  
BASED UPON INFORMATION FURNISHED BY THE  
JOINT MEETING OF ESSEX AND UNION COUNTY  
SEWERAGE AUTHORITY.

THIS SHEET IS A SCANNED COPY OF THE TAX MAP PREPARED  
BY APPRAISAL SURVEYS INC. SEPTEMBER, 1967. THE ORIGINAL  
APPROVED MAP IS ON FILE IN THE ASSESSORS OFFICE.

NEW JERSEY DEPARTMENT OF THE TREASURY  
DIVISION OF TAXATION  
PROPERTY ADMINISTRATION TAX MAP SECTION  
APPROVED AS A TAX MAP PURSUANT TO THE  
AUTHORITY OF N.J.S.A. 54:1-15 & N.J.S.A. 54:50-1  
FOR THE DIRECTOR, DIVISION OF TAXATION  
  
Sue Davison CTA Supervising Field Rep  
Sue Davison, CTA Supervising Field Rep  
DATE: SEP 11 2013 SERIAL NO. 1025

**TAX MAP**  
**TOWNSHIP OF IRVINGTON**  
ESSEX COUNTY, NEW JERSEY  
SCALE 1" = 80' DATE 1/31/2013  
**CASEY & KELLER, INC.**  
**MICHAEL LANZAFAMA, PLS**  
258 MAIN ST. MILLBURN, NJ 07041  
TO SHOW CONDITIONS AS OF JANUARY 31, 2013